

VDI SAFETY



MICRO

TITAN

TPH

TPS

TPSP

TPF

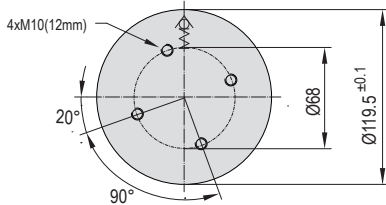
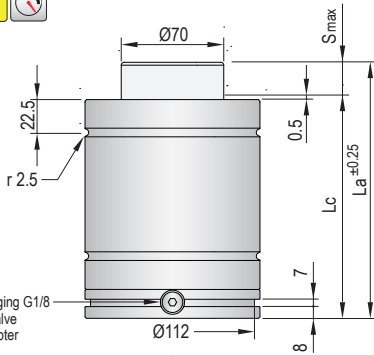

Under request

- Pressure medium **Nitrogen (N₂)**
- Max. charging pressure **150 Bar**
- Min. charging pressure **50 Bar**
- Piston seal area **78,54 cm²**
- Operating temperature **0°C - 80°C**
- Force increase by temperature **0,33 %/°C**
- Max. stem speed **25 m/min**
- Maintenance kit **Kit F11800C**



Maximum strokes / minute (at 20°C)

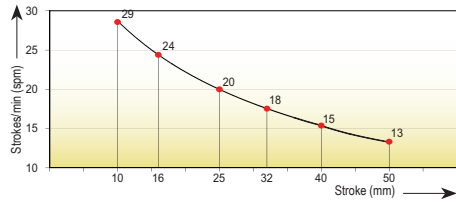

Code	Smax mm	La mm	Lc mm	Fa daN	85% F daN	100% Fc daN	P Bar	V l	Kg		
TPF 11800x10 C	10	120	110	11800 ±5% (20°C)	14805	15505	150 (20°C)	0,327	7,10		
TPF 11800x16 C	16	146	130		15165	15975				0,479	7,89
TPF 11800x25 C	25	175	150		15835	16860				0,652	8,65
TPF 11800x32 C	32	207	175		15670	16640				0,861	9,46
TPF 11800x40 C	40	240	200		15690	16665				1,072	10,41
TPF 11800x50 C	50	280	230		15745	16740				1,326	11,65

Attention!
This model is designed to work in a hose system.

Force/stroke ratio

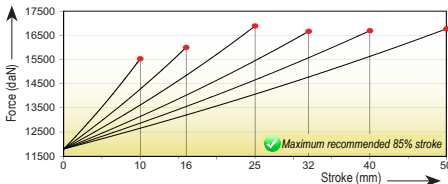

Initial force/charging pressure ratio

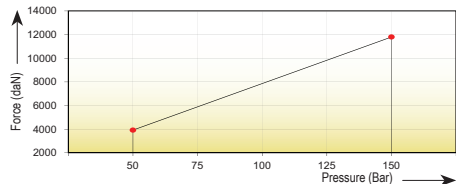

Assembly possibilities

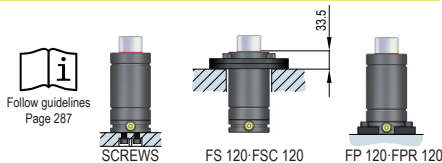

Follow guidelines
Page 287

Connection alternatives

